



Architect and Engineer Specification

CO₂ Suppression System

LATCH DOOR TYPE PULL BOX

CATALOG
NUMBER
E.1.24.01

P/N C70-242

UL - Ex 4447
USCG - 162.038/12/0

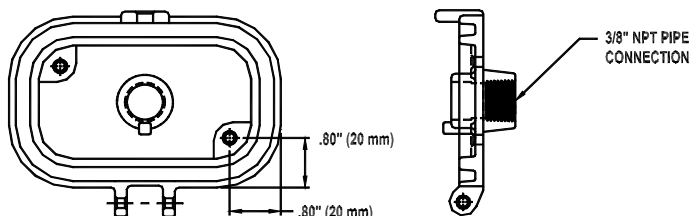

DESCRIPTION

The Latch Door Pull Box on a carbon dioxide system is used to provide mechanical operation of the Stop/Selector Valve and/or the Local Lever Actuator from a remote location. The Latch Door Pull Box has a solid cast brass door that must be opened in order to access the pull handle. The pull handle is attached to a 1/16" (2 mm) diameter stainless steel actuation cable. A 3/8" NPT female opening is provided in the back of the enclosure for connection of the cable and piping system.

A Corner Pulley may be attached directly to the back of the Pull Box if an immediate change of direction is necessary. Up to 100 ft. (30.5 m) of cable, and a maximum of fifteen (15) Corner Pulleys may be used for each cable run.

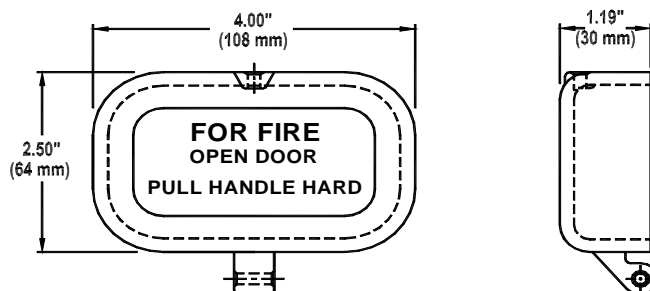

SPECIFICATIONS

Materials: Pull Box – Brass
Paint – Red polyurethane paint

July, 2002
Revised Issue

This page intentionally left blank